

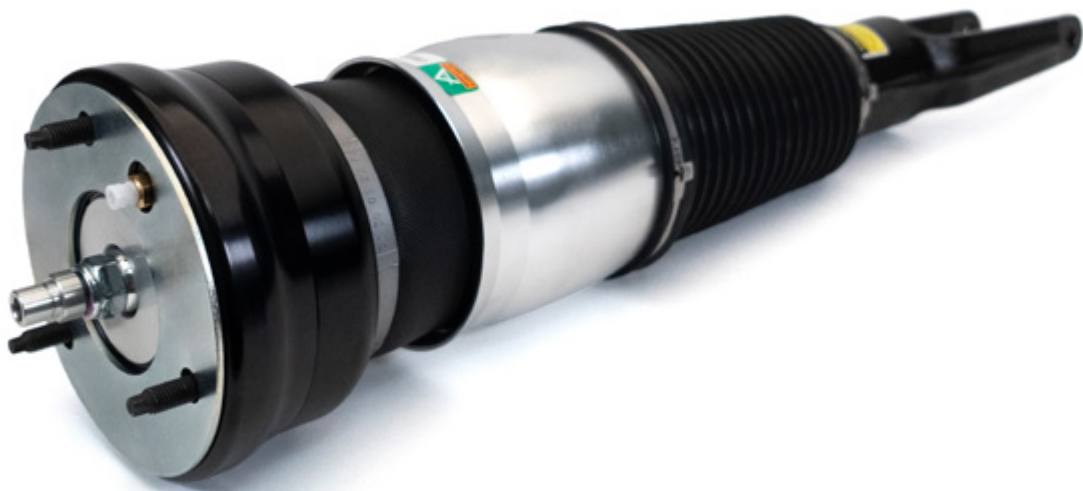

INSTALLATION MANUAL

ASE-4028

**Arnott New Front Left Electronic eRide Strut
Porsche Panamera (970.2 Chassis (G2))**



Engineered to Ride, Built to Last®

CONGRATULATIONS ON YOUR PURCHASE OF AN ARNOTT® SUSPENSION PRODUCT

WE AT ARNOTT LLC ARE PROUD TO OFFER A HIGH QUALITY PRODUCT WITH ALL THE TECHNICAL SUPPORT YOU NEED. THANK YOU FOR YOUR CONFIDENCE IN US AND OUR PRODUCT.

Proper installation is essential to experience and appreciate the benefits of this system. Please take a moment to review these installation instructions before you begin to install these components on your vehicle. The removal and installation of air suspension products should only be performed by a fully qualified and certified automotive professional.

It is equally important to be aware of all necessary safety measures while installing your new Air Suspension System. This includes proper lifting and immobilizing of the vehicle and isolation of any stored energy to prevent personal injury or property damage.

GENERAL INFORMATION

Reading this manual signifies your agreement to the terms of the general release, waiver of liability, and hold harmless agreement, the full text of which is available at www.Arnottinc.com and www.Arnotteurope.com.



WARNING:

The air suspension system is under pressure (up to 10 bar, or 150 lbf/in). Verify pressure has been relieved and disconnect power to the air suspension system prior to disassembly. Do not allow dirt or grease to enter the system. Always wear standard hand, ear, and eye protection when servicing the air suspension system.

- Not to be stored below 5°F (-15°C) and above 122°F (50°C).
- Avoid damage to air lines and cables.
- Removal and installation is only to be performed by fully qualified personnel.
- Use car manufacturer's diagnostic software.

CAUTION:

Damage to the vehicle and air suspension system can be incurred if work is carried out in a manner other than specified in the instructions or in a different sequence.

To avoid the possibility of short circuits while working with electric components consult your owner's manual on how to disconnect your battery.

Consult your vehicle owner's manual, service manual, or car dealer for the correct jacking points on your vehicle and for additional care, safety and maintenance instructions. Under no circumstances should any work be completed underneath the vehicle if it is not adequately supported, as serious injuries and death can occur.

For vehicles with a "Closed Air Supply System," replacement of components requires proper adherence to procedures set forth within OE servicing literature. Failure to comply with the OE prescribed procedures can result in component damage and/or failure.

NOTE:

This vehicle contains a “Closed Air Supply System”. Replacement of components requires proper adherence to procedures set forth within OE servicing literature. Failure to comply with the OE prescribed procedures can result in component damage and/or failure.

AIR STRUT REMOVAL

1. Set steering to straight ahead.
2. Raise vehicle.
3. Remove applicable front wheel. (Figure 1)

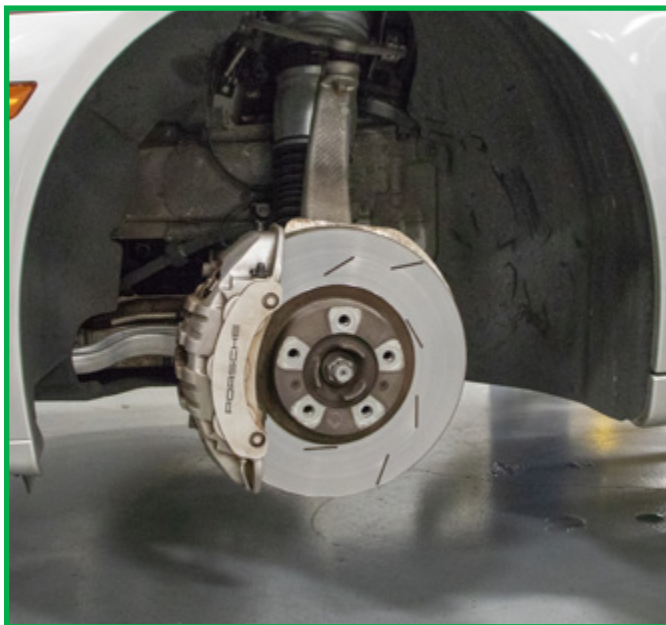

FIGURE 1

4. Remove the upper plastic cover that sits above the air strut. (Figure 2)



FIGURE 2

5. Disconnect the strut connector retaining clip. (Figure 3)



FIGURE 3

6. Disconnect the top electrical plug. (Figure 4)

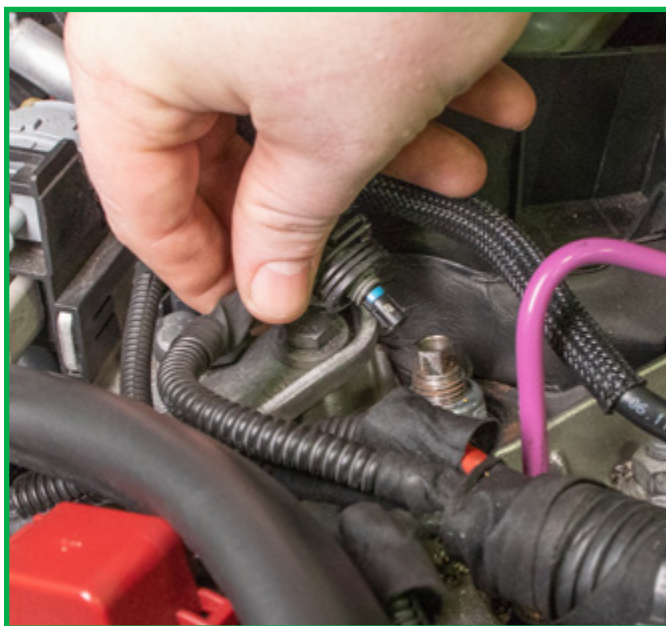

FIGURE 4

7. Disconnect the air line and remove the air fitting. (Figures 5, 6)



FIGURE 5

REMOVAL



Prior to inserting the existing air line into the new air strut you will need to remove the old original equipment air line fitting and discard.

NOTE:

Scratches and/or deep cuts in the air line can result in possible leaks. Inspect the air line before insertion. Air line needs to be replaced if damaged.

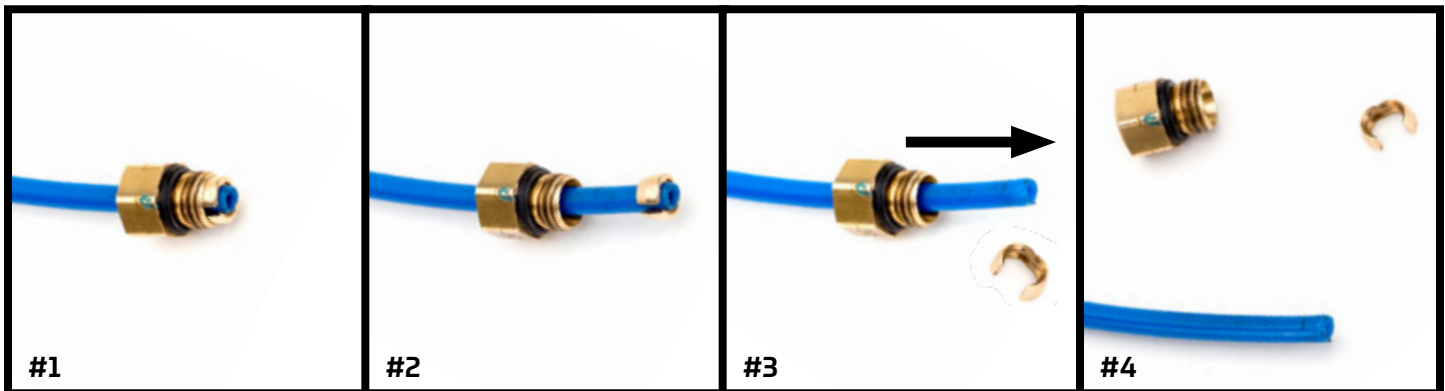

#1
OE AIR LINE FITTING

#2
SLIDE THE THREADED
PORTION UP THE LINE
AND SPREAD THE COLLET
OPEN TO REMOVE

#3
SLIDE THE AIR FITTING
OFF OF THE AIR LINE

#4
DISCARD OE AIR LINE
FITTING

FIGURE 6

8. Loosen and remove the three top shock mounting nuts. (Figure 7)

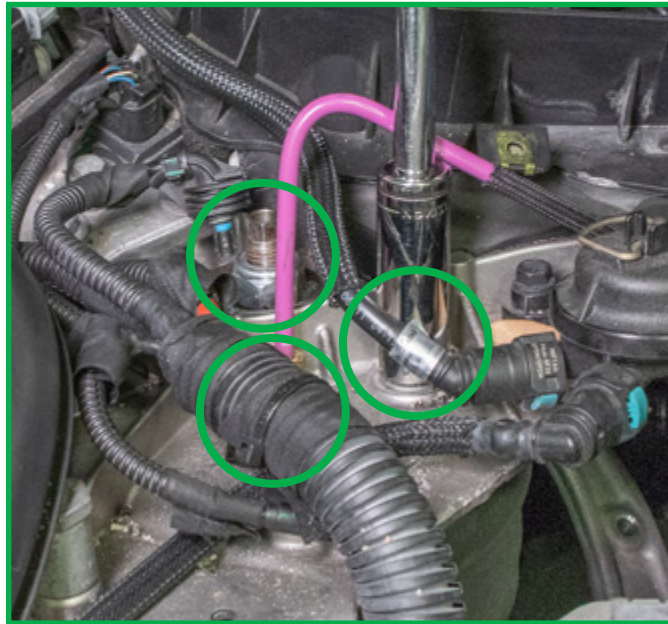

FIGURE 7

9. Disconnect the wheel speed sensor. (Figure 8)



FIGURE 8

10. Detach the wheel speed sensor wires from their retention brackets. (Figures 9, 10, 11)

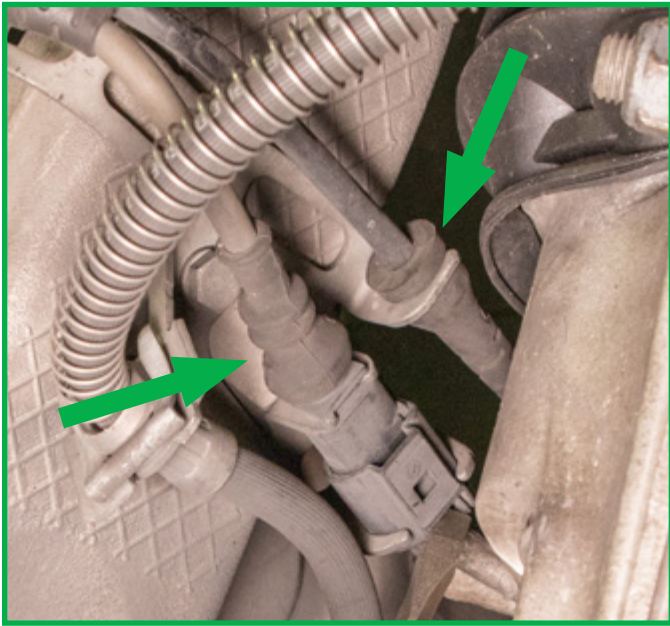

FIGURE 9

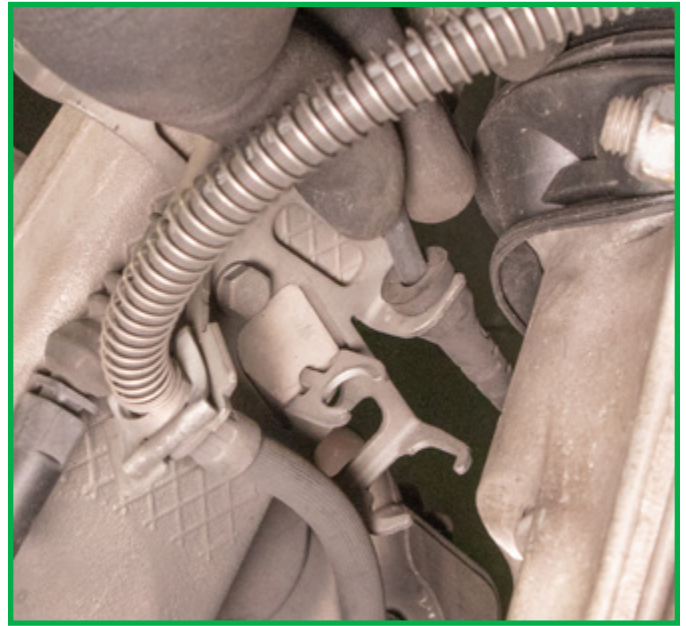

FIGURE 10



FIGURE 11

11. Loosen and remove the sway bar end link nut and separate from the strut. (Figure 12)

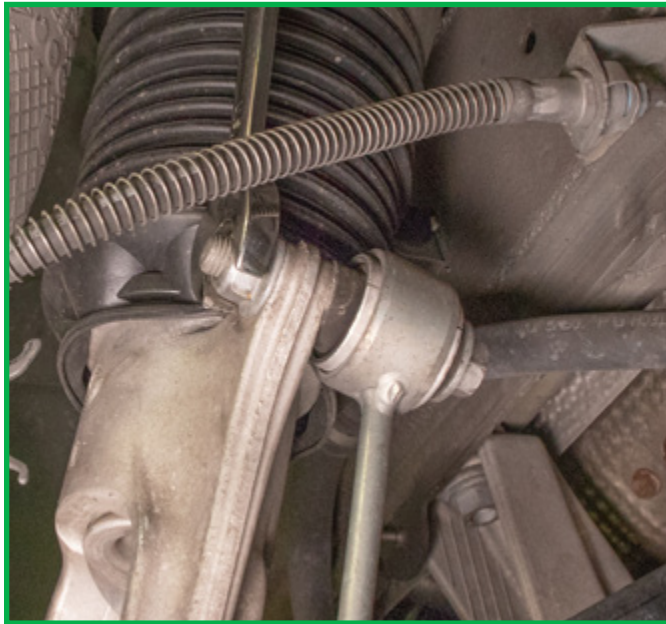

FIGURE 12

12. Loosen and remove the bottom mount nut and bolt. (Figure 13)



FIGURE 13

13. Loosen and remove the upper ball joint nut and separate the ball joint from the spindle assembly. (Figure 14)



FIGURE 14

14. Remove the air strut from the vehicle. (Figure 15)



FIGURE 15

15. Removal complete.

eRide STRUT INSTALLATION



WARNING:

Tighten all nuts and bolts to manufacturer's specifications during the installation process.



WARNING:

Do not remove the air fitting from the air strut. Doing so may cause damage and/or void warranty. Remove the white shipping pin from the new air fitting and insert the air line until fully seated.

1. Install the air shock into the vehicle. (Figure 16)



FIGURE 16

2. Install the bottom mounting bolt and nut and tighten to manufacturer's specifications. (Figures 17, 18)

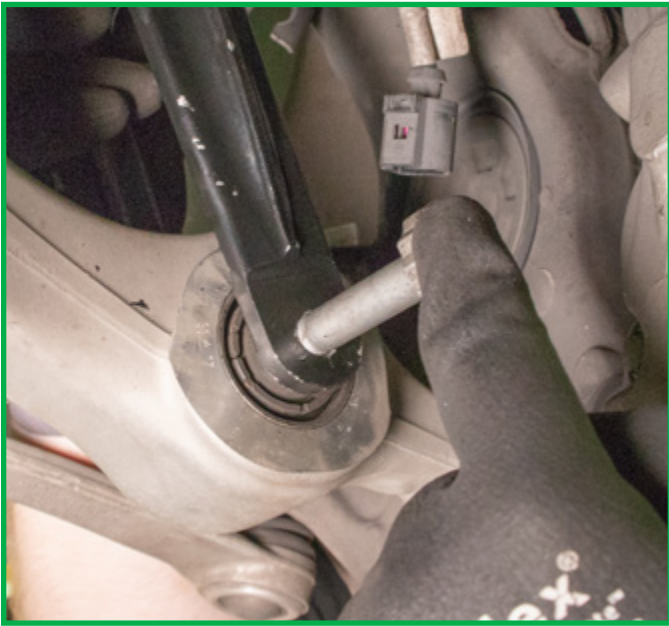

FIGURE 17

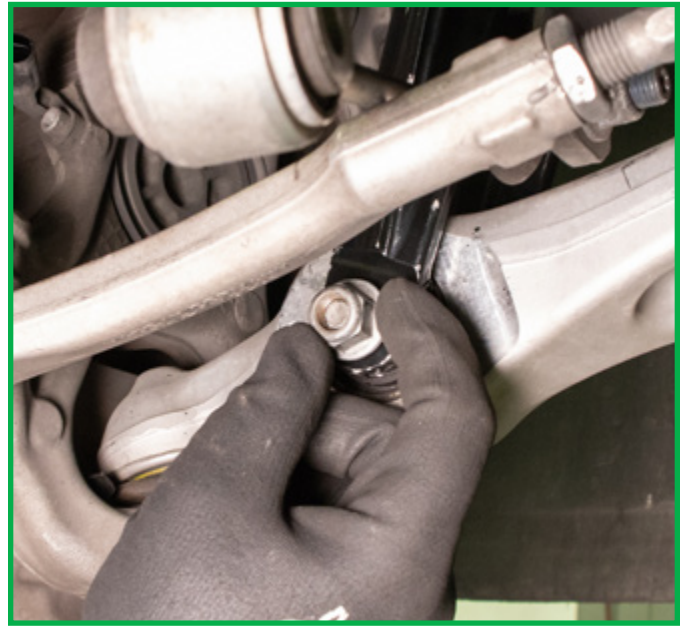

FIGURE 18

3. Reattach the sway bar end link. Reinstall the sway bar end link nut and tighten to manufacturer's specifications. (Figure 19)



FIGURE 19

4. Reattach the upper ball joint to the spindle assembly. Install the nut and tighten to manufacturer's specifications. (Figure 20)



FIGURE 20

5. Reinstall the top shock mounting nuts and tighten to manufacturer's specifications. (Figure 21)

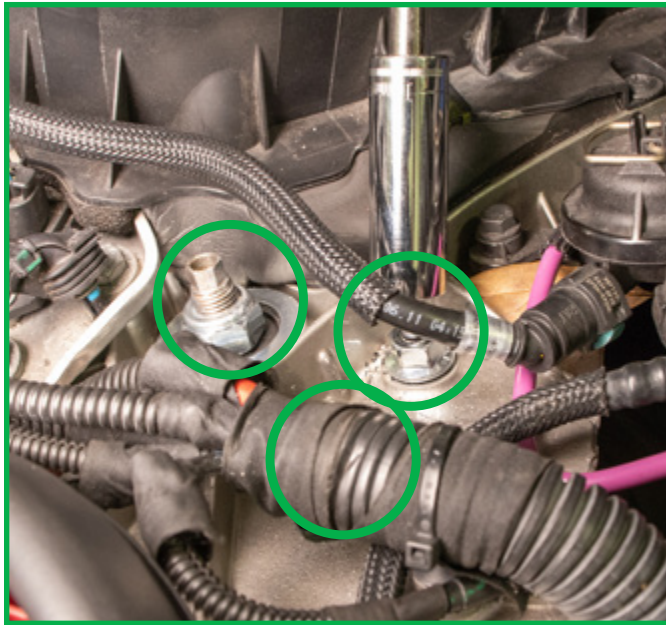

FIGURE 21

6. Reinstall the air line. (Figure 22)

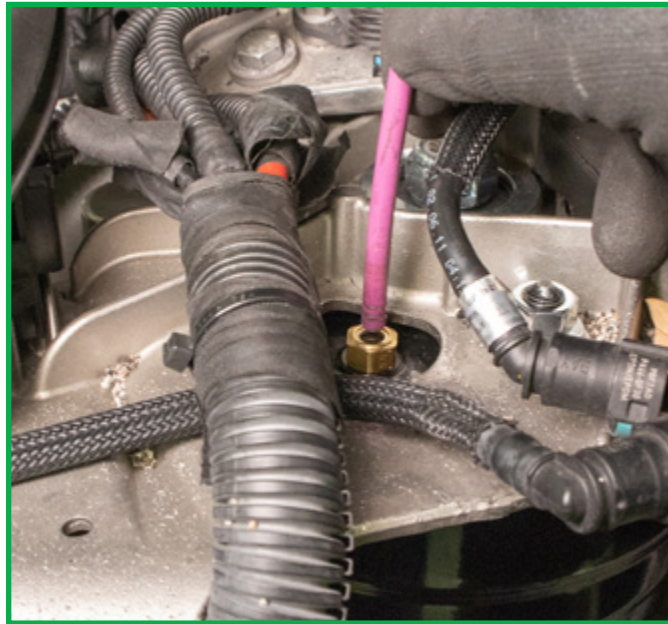
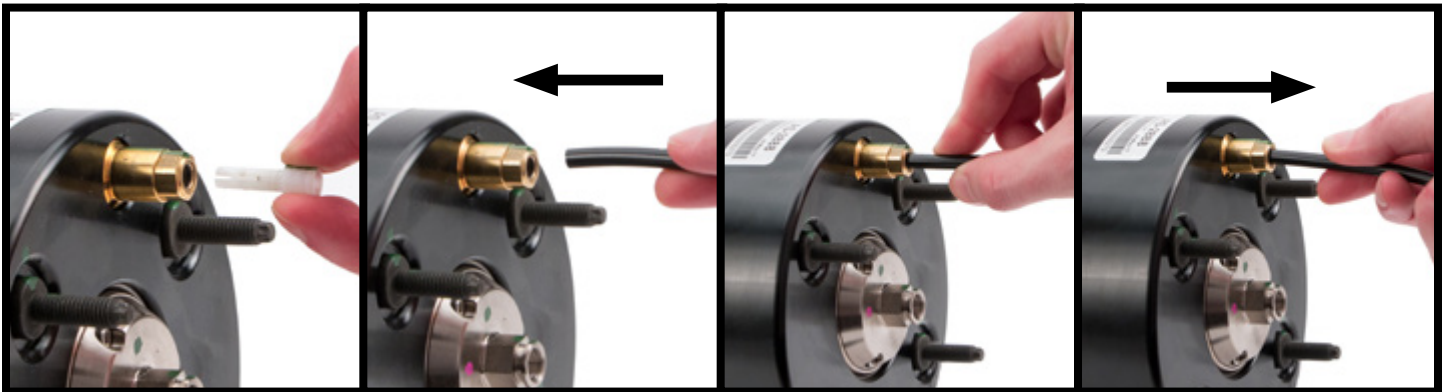

FIGURE 22



REMOVE AND DISPOSE OF
THE SHIPPING PIN.

INSERT AIR LINE INTO
THE AIR LINE FITTING
UNTIL IT STOPS.

AIR LINE INSERTED.

GENTLY PULL ON AIR
LINE TO CONFIRM IT IS
FULLY SECURED BY THE
AIR LINE FITTING.

7. Reinstall top electrical plug, being careful to appropriately orient the electrical connection to align the pins. (Figure 23)



FIGURE 23

8. Reinstall the strut connector retaining clip. (Figure 24)

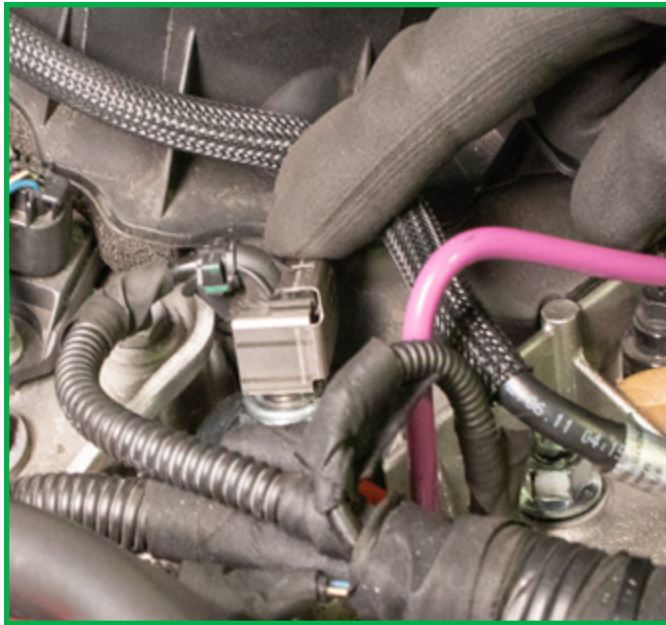

FIGURE 24

9. Reattach the wheel speed sensor wires to the mounting brackets. (Figures 25, 26, 27)

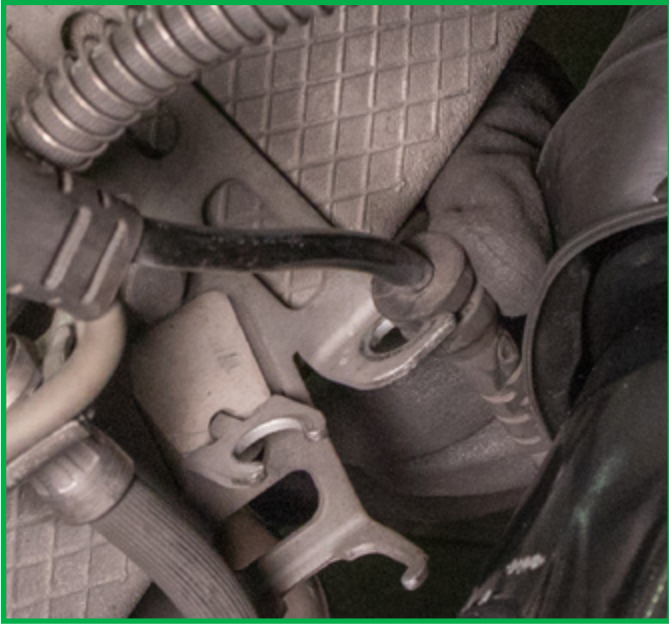

FIGURE 25

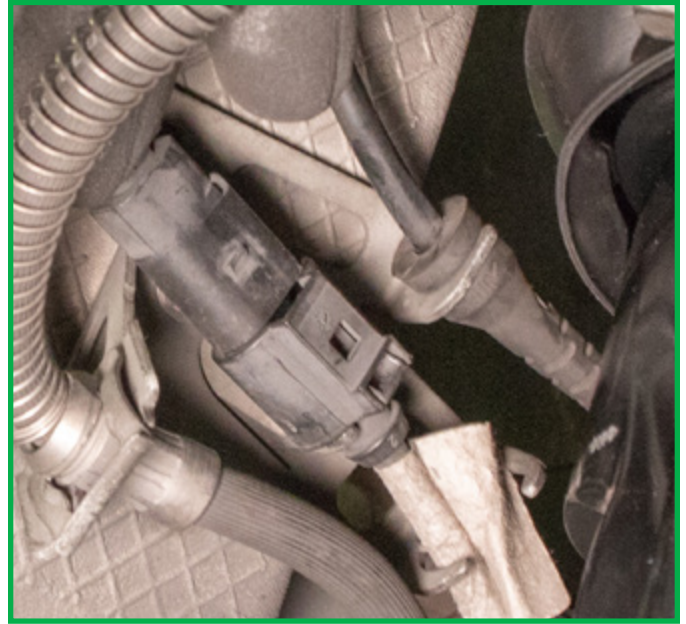

FIGURE 26



FIGURE 27

10. Reconnect the wheel speed sensor. (Figure 28)



FIGURE 28

11. Reinstall the upper plastic cover. (Figure 29)



FIGURE 29

- 12. Reinstall the wheel.
- 13. Lower the vehicle.
- 14. Installation complete.

NOTE:

This vehicle contains a "Closed Air Supply System". Replacement of components requires proper adherence to procedures set forth within OE servicing literature. Failure to comply with the OE prescribed procedures can result in component damage and/or failure.

Arnott™

Suspension Products

Arnott US Business Office:

www.Arnottinc.com

100 Sea Ray Drive
Merritt Island, FL 32953

Call: 800.251.8993

321.868.3016

Fax: 321.868.3703

Email: techassistance@Arnottinc.com

Arnott Europe Business Office:

www.Arnotteurope.com

Docterskampstraat 1E/1F, 3
5222 AM 's-Hertogenbosch (NL)

NL Phone: +31 73 7850 580

DE Phone: +31 85 2087 438

UK Phone: +44 203 3186 124

BE Phone: +32 258 846 90

ES Phone: +34 91 901 10 56

FR Phone: +32 78 48 46 93

Email: info@Arnotteurope.com



Air Springs

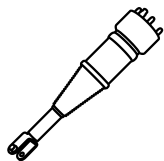

Struts

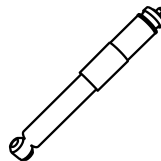

Shocks

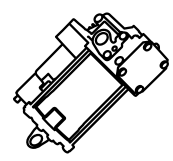

Compressors

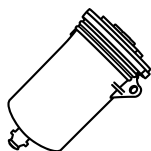

Dryers

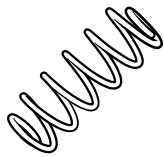

Coil Spring
Conversion Kits

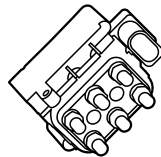

Valve Blocks

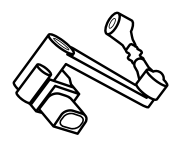

Ride Height
Sensors